

# Helpful Instructions For Making The Perfect Bead

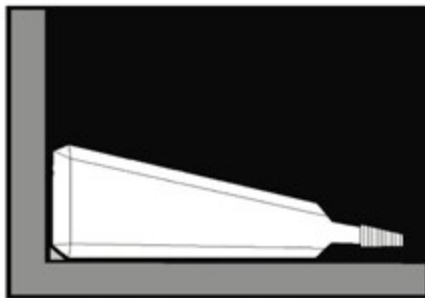

ON



Beveled edges are designed to function as a squeegee and must face direction of excess caulk removal. Small corner beveled edge pushes caulk into gap and leaves proper amount of caulk. If larger caulk bead is necessary, cut small corner beveled edge to desired shape to allow for more caulk and a larger bead.

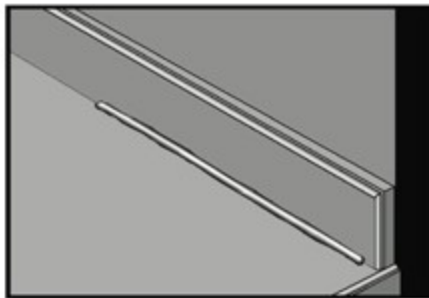

1.) Place small bead of Color Rite in joint. Bead should be approximately 1/8" x 1/8" to avoid waste.

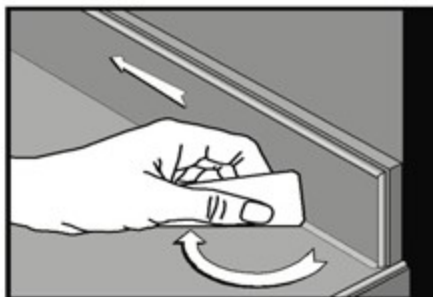

2.) Place longest beveled edge of the PERFECT BEAD TOOL on the horizontal surface and rotate small tip in direction of excess caulk removal.

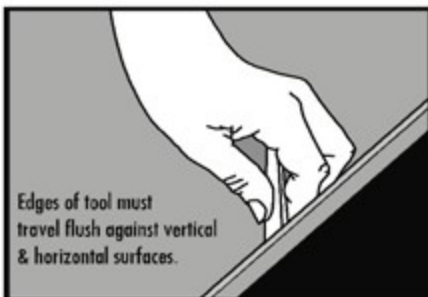

Edges of tool must travel flush against vertical & horizontal surfaces.

3.) Tilt the PERFECT BEAD TOOL towards vertical splash surface until short beveled edge touches vertical splash surface.

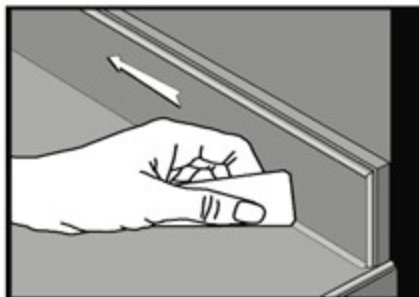

4.) Using moderate pressure, move the PERFECT BEAD TOOL along caulk normally with one pass. Intermittent removal of excess caulk from tool is suggested for best performance. If smoother caulk bead is required repeat steps 2 through 4.

The PERFECT BEAD TOOL is available in:  
Convenient 10 packs

Profile of caulk bead as it is applied.

Profile of caulk bead after tooling with the PERFECT BEAD TOOL.

Use of the PERFECT BEAD TOOL eliminates feathered edges which contribute to caulk adhesion failures and unsightly caulk bead created using typical tooling procedures.

Profile of caulk bead as it is applied.

Profile of caulk bead after typical application.

got caulking?  
CHOICE OF PROFESSIONALS  
WWW.COLORRITEINC.COM

1-855-82CAULK  
WE SEAL THE DEAL

color RITE  
INCORPORATED